

Directives related to COVID-19 on the Small Animal Preclinical Imaging Platform (PIPPA)

PREAMBLE

Access to the buildings will only be granted to employees whose activities require a physical presence. All activities that do not involve physical manipulation (data analysis, writing, laboratory meetings, journal club, etc.) must be carried out from home. People presenting one or more known symptoms of Covid-19 must follow the self-isolation and self-quarantine rules set by the FOPH. Persons at especially high-risk (as defined by the FOPH) must work from home.

Authorised persons on the PIPPA facility: **Didier Colin, Olivia Bejuy, Stéphane Germain**

Staff will access to the facility only if the activities require a physical presence (image acquisition, assistance to researcher, maintenance, etc.). All the activities that do not require a physical presence will be achieved from home (image analyses, remote assistance, meetings, administrative duties, etc.).

Collaborators who must access to the facility for the experiments, need training or assistance will have to contact the staff **at least 72h in advance** by email or phone. Staff will organise the sessions for the collaborators to limit physical contacts.

Contacts

Didier Colin : didier.colin@unige.ch / +33 (0)6 74 33 06 97

Olivia Bejuy : olivia.bejuy@unige.ch / +33 (0)6 07 50 05 74

Stéphane Germain : stephane.germain@unige.ch / +33 (0)6 76 17 15 76

Reference

<https://www.unige.ch/medecine/fr/recherche/covid-19-informations-relatives-aux-activites-de-recherches/>

SOCIAL DISTANCING

In order to respect social distancing measures, the number of people is limited by the typology of laboratories.

- **Imaging room** (106,20 m² - Type IV) : a maximum of 4 persons are allowed simultaneously, announced **72h in advance**.
/ ! \ The room is composed of 4 type I boxes, **only one person is authorised per box at any time**. This means that the IVIS and the μ CT cannot be used simultaneously.
- **ICONEUS** (< 22 m² - Type I): only one person is authorised at any time.
- **Surgery and dose preparation rooms** (< 22m² – Type I): only one person is authorised at any time.
- **Animal storage rooms** (< 22m² – Type I): only one person is authorised at any time.

- **Radiobiology lab** (25.76 m² – Type II): a maximum of two persons are authorised at any time, **surgical masks must be worn**.
- **Analyses office** (< 22 m² – Type I): only one person is authorised at any time, announced **72h in advance**.
- **Staff office** (25,76 m² - Type II): a maximum of two persons are authorised at any time, **surgical masks must be worn**.

COMPULSORY MEASURES

- Users who present symptoms or are COVID-19 positive are not allowed to access the facility.
- Users who have been in contact with COVID-19 positive persons or have been in risk areas are not allowed to access the facility for **14 days**.
- Vulnerable persons must stay at home and ask to colleagues to perform their experiments.
- If the activity does not allow these rules to be respected or requires close contact (<2 m), **surgical masks must be worn**.
- Collaborators performing experiments on imaging devices must wear **gloves and a surgical mask**.
- Before and after experiments on imaging devices or workstations, all the surfaces must be cleaned with **70% ethanol**, collaborators must wait **10 minutes** before use.
- Collaborators who need to have access to analyses software available on the facility should ask free trial licences to distributors. If not possible, remote access to workstations of the facility can be considered after approval by the staff.

ANNEXE – MAP OF PIPPA

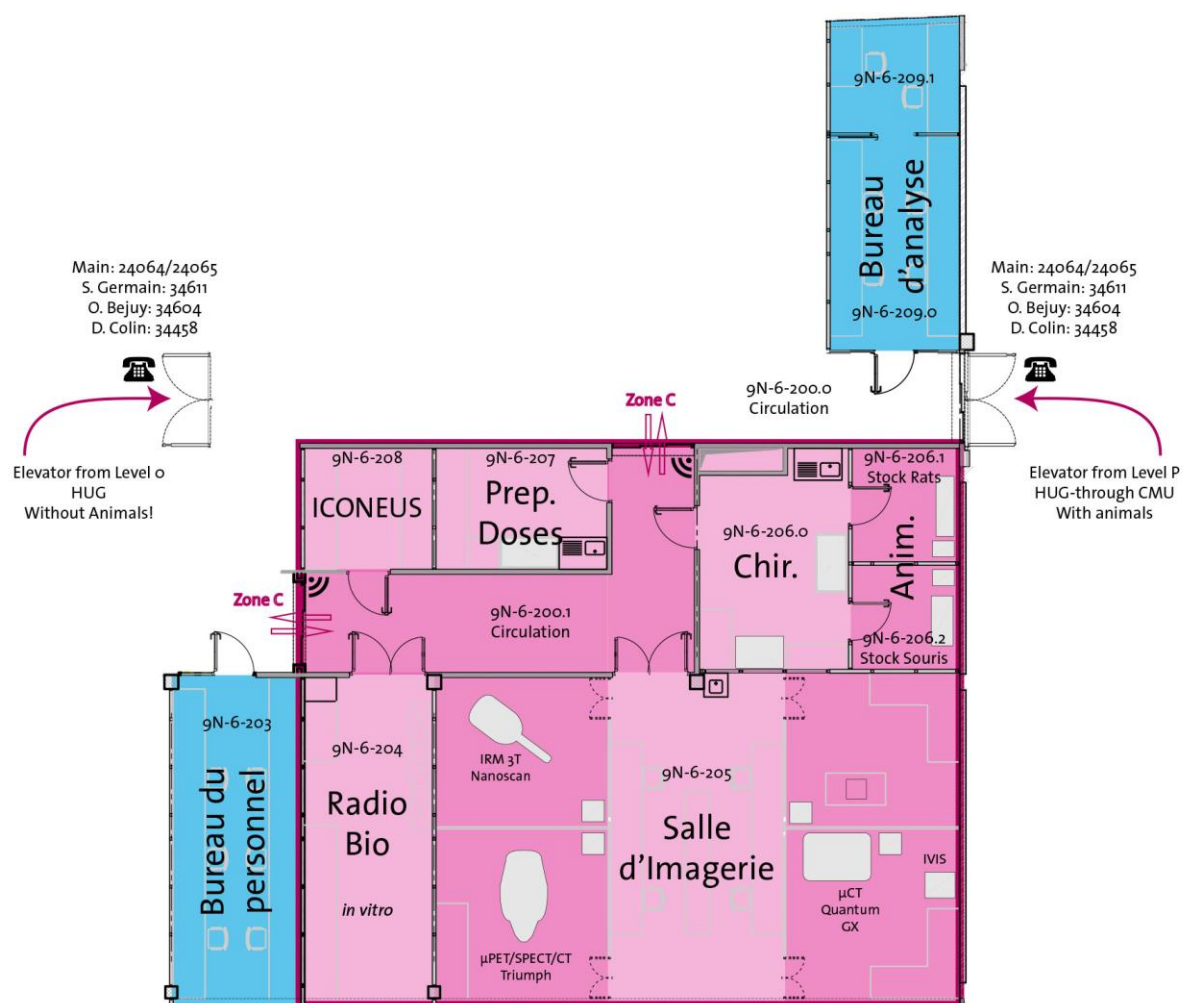



COVID-19 -related hygienic instructions



Staff **MUST BE CONTACTED 72 H IN ADVANCE** by email or phone for **BOOKING**.

Staff is available by email or phone to ensure any assistance, remote access to computers for data retrieval and analyses.

Didier Colin : +33 6 74 33 06 97 / Olivia Bejuy: +33 6 07 50 05 74 / Stéphane Germain: +33 6 76 17 15 76



Do not use the platform if you are **sick** (+/- symptoms), or if you have been in contact with **contaminated persons** in the **last 14 days**.



Contact the **staff** by email or phone for **booking** at least **72h** in advance.

Focus on **software** that can be easily **installed on your personal computers**. Remote access to platform computers can be considered.



Maintain **social distancing** all the time.

Only one person is authorized **per instrument** or **per box** (e.g. Quantum-CT and IVIS scanners cannot be used at the same time).



Wash your hands with soap & water or use hydroalcoholic gel.
Dispose of **used paper tissues** in **dedicated waste bins**.

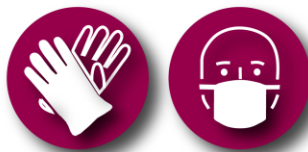

Use **new gloves** (available next to scanners), and wear your **surgical mask**.

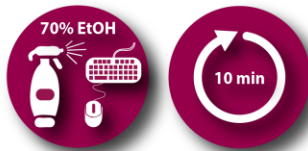

Before starting your session:

- (1) **Wash all contact surfaces with 70% EtOH on a cleaning tissue** (keyboard, mouse, equipment, etc...),
- (2) **Wait 10 minutes**.

At the end of your session: **repeat (1), (2) & trash cleaning tissues in dedicated waste bins**.